

MAISON

RIVERSIDE ESTATE





BONJOUR RIVIÈRE.

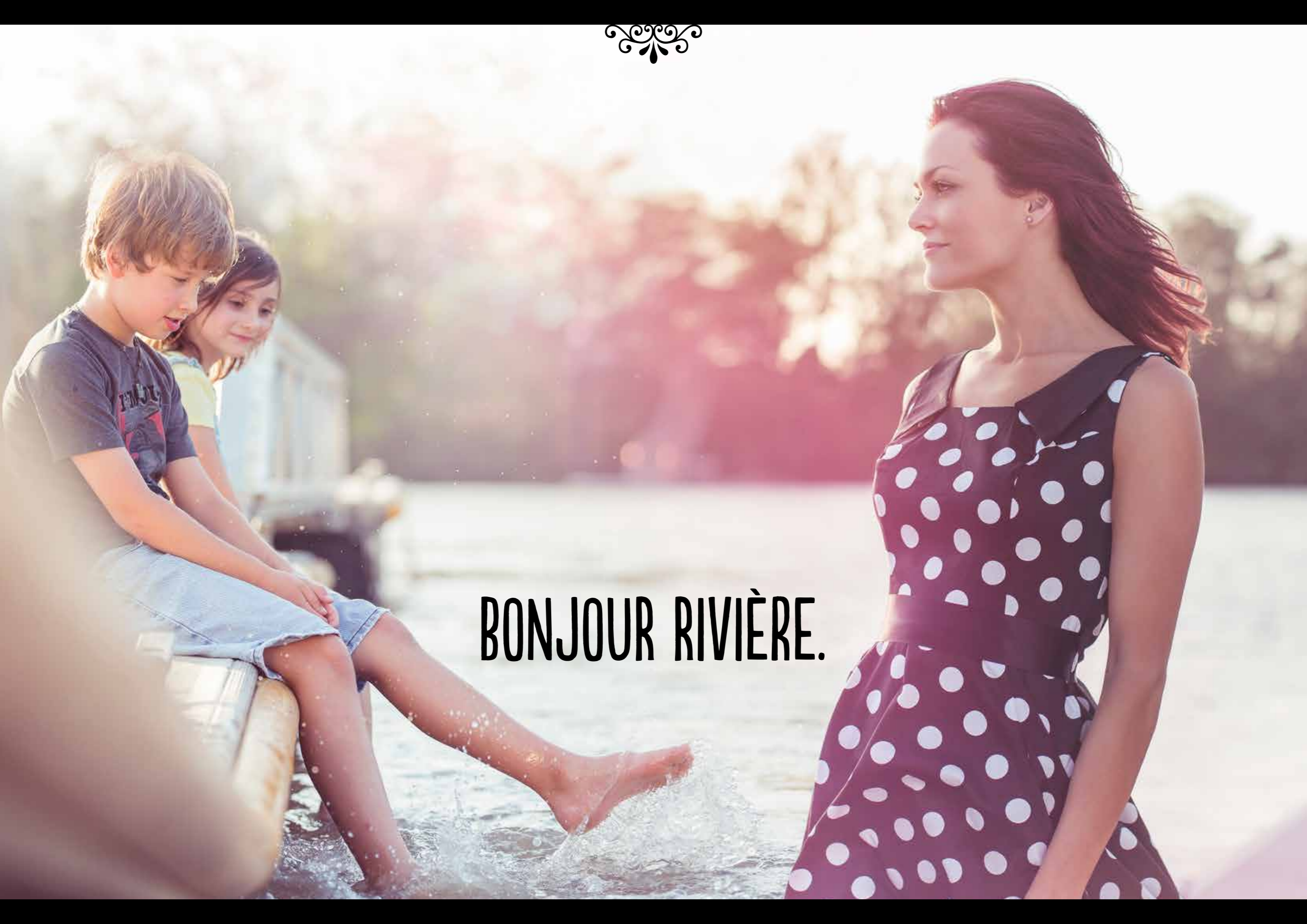



“*‘Maison’ means home in French and this community is built around the idea of your family coming home to a feeling of Europe by the water.*”

BONJOUR!
WELCOME TO MAISON
RIVERSIDE ESTATE.

Living by the river is a rare privilege, water has the power to change the way a home, a landscape, or a family feels. The built and landscape form of Maison reflect the name of the estate, the finest quality materials and workmanship combine with French influence to create something truly exquisite.

Entertain with the river as your backdrop, the pinnacle of living in Brisbane, now within your reach.



LANDSCAPE TREATMENT

Welcome home to Maison Riverside Estate. As you wind down Riviere Place past the stunning white french gazebo, with the glistening Brisbane river in the back ground, your sense of belonging to a riverside community is ever present. Take an afternoon stroll in the 12,000 sqm riverside parklands, or pull up on one of the classic style park benches and let the river breezes and views soothe the day's work and stress away. Why not have a picnic in the gazebo and let the kids swing to their hearts content on the swings directly overlooking the river. The kids can spend endless hours down by the rivers edge exploring and enjoying the outdoors. When entertaining, you will be proud to give directions to turning left at the grand entry statement, with sandstone clad feature wall and wrought iron estate signage. This estate is like nothing else you have ever experienced...



✿ **Entry feature** - Wrought iron floats above a vine covered sandstone wall. The entry statement evokes classic style and class

✿ **Feature sandstone retaining walls** - crafted in random sandstone by experienced stone masons

✿ **Gazebo** - The French style Gazebo with wrought iron inlays overlooks the water and captures the imagination

✿ **Park benches** - Ornate style park benches take in the views over the park to the river

✿ **Bollards** - Its all the fine details that add to the whole experience, and nothing has been omitted, solid 150x150 square hardwood bollards are adorned with stainless steel caps

✿ **Play Area** - The distinct and simple T-swing complements the estate style and provides leisure for children

✿ **Street lights** - "Nostalgia" design, an elegant and clean form



All images, maps, plans, and artist impressions are indicative only, they are subject to change and may not accurately reflect the final blocks of land and associated roads and parkland.

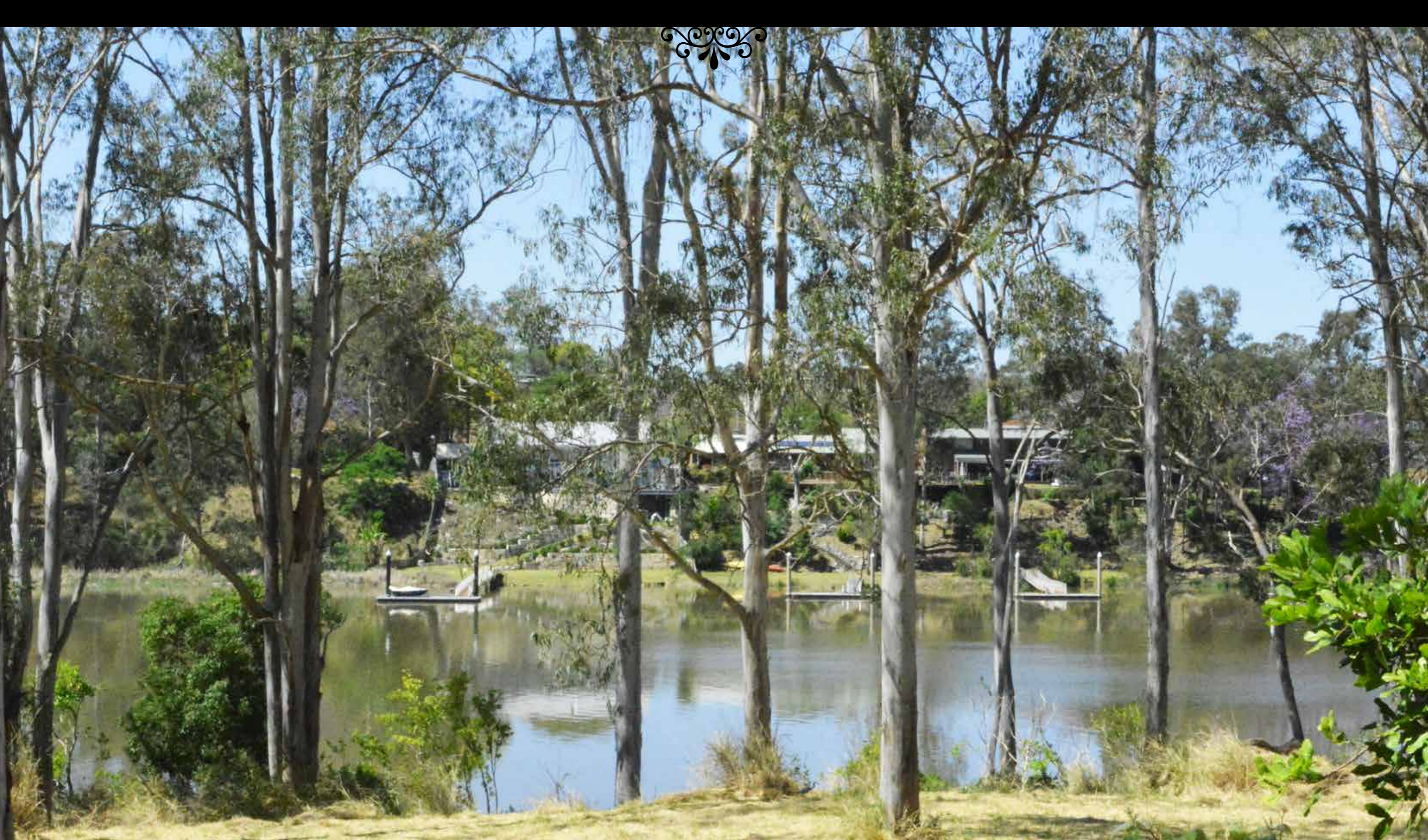

RIVER VIEWS

Wouldn't YOU like this view...

Almost all homesites in Maison Riverside Estate enjoy substantial views to the Brisbane River. Please request the river sightline analysis plans completed by Gerard Lynch of award winning architect HAL from your estate agent.

HOUSE & LAND PACKAGES

Living at Maison Riverside Estate is a privilege. Rarely do you find a new estate 10km to the CBD with blocks enjoying riverviews. The exciting release of stage two of the estate showcases the premium hillside blocks. Think European hillside community overlooking the water. Sloping blocks offer so much choice and possibility for beautiful home design and designs that take advantage of once in a lifetime views. We have engaged select builders to give you a vision of what is possible for a house and land package at breathtaking price points when you consider what is on offer.

Visit the House and Land Package page on the website for current availability.



ESTATE PLAN

PROPERTIES ARE SELLING FAST SO
CONTACT YOUR ESTATE AGENT
FOR HOUSE AND LAND PACKAGE
OPTIONS, PRICES, AND INDIVIDUAL
DETAILED LOT PLANS.
102 SUNSET ROAD, KENMORE.

MAISON
RIVERSIDE ESTATE

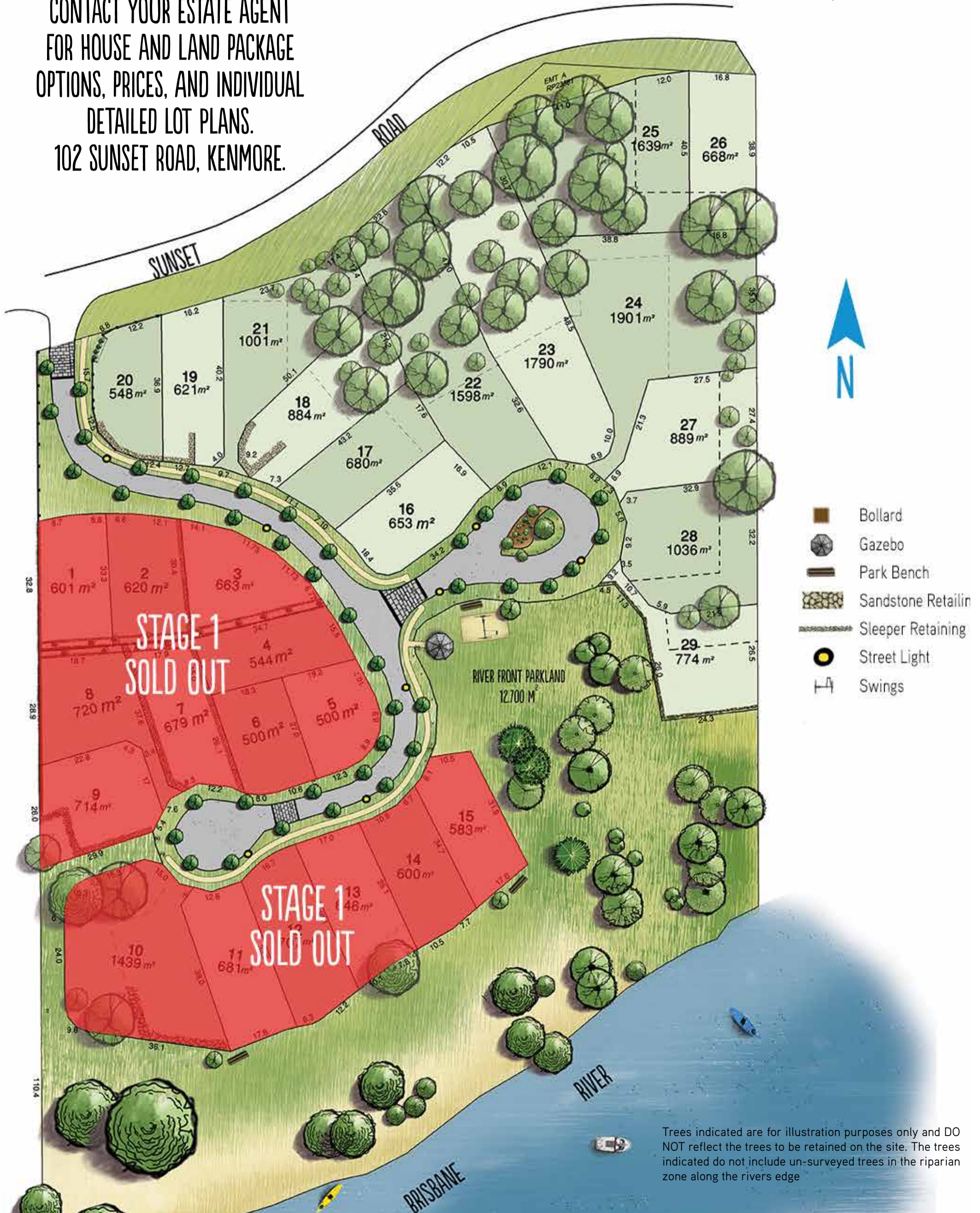

Trees indicated are for illustration purposes only and DO NOT reflect the trees to be retained on the site. The trees indicated do not include un-surveyed trees in the riparian zone along the rivers edge



SITE MAP

MT COOTHA

CBD

UNIVERSITY
OF
QUEENSLAND

LEGACY WAY
4 MINS TO CBD
NOW OPEN

INDOOROPILLY
SHOPPING CENTRE

KENMORE PLAZA
SHOPPING CENTRE

INDOOROPILLY
GOLF CLUB

The logo for 'MAISON RIVERSIDE ESTATE' is centered within a black speech bubble. It features the word 'MAISON' in a large, stylized serif font, with 'RIVERSIDE ESTATE' in a smaller, simpler font below it. The entire text is flanked by decorative scrollwork.

YOUR NEW
HOME?





PREMIUM QUALITY ESTATE
RIVER VIEWS
10 KM TO THE BRISBANE CBD
WESTERN SUBURBS
LIMITED RELEASE

MAKE THE RIGHT DECISION AND SECURE YOUR FUTURE TODAY
PLEASE CALL 1300 720 433 FOR A COPY OF THE RIVER SIGHT LINE PLANS, PRICING,
AND FOR YOUR PERSONAL ONSITE TOUR OF MAISON RIVERSIDE ESTATE.

sales@maisonestate.com.au
maisonestate.com.au

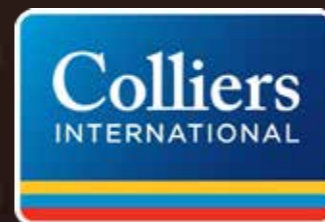

This document provides general information only. Individuals should not rely on it for their own circumstances, about which they should take their own professional advice. No warranty or promise is made in relation to any of the information provided herein. The details of this document are expressly excluded from all and any legal documents. Photographs, lot plans, landscaping plans and illustrations are indicative only and may have been digitally enhanced. Lot plan configuration may differ from that shown once completed. Future development is subject to final approval by government authorities. Neither the owner, nor its agents, accept any responsibility for changes, errors or omissions. For allotment areas and dimensions see relevant disclosure plans or registered plans of survey.